

BC COUPLING

บริษัท แอสสิริ การพาณิชย์ จำกัด

CL COUPLING

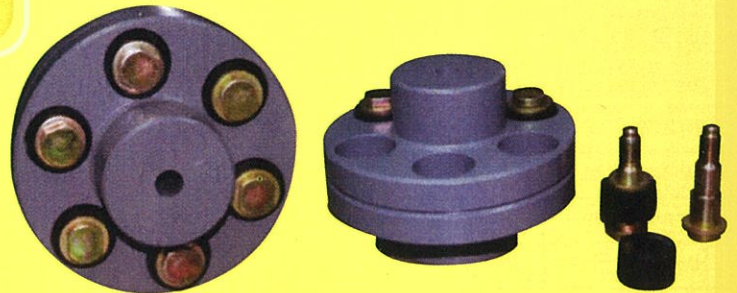
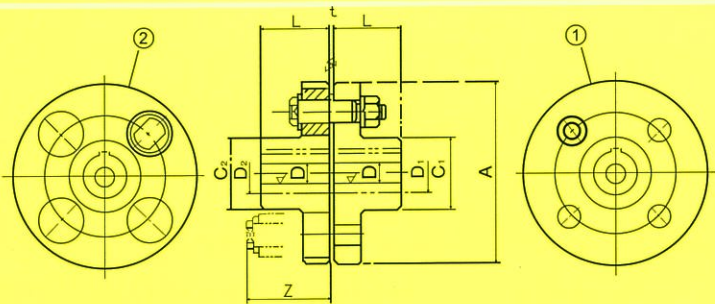

(mm.)

Type Number A	Max. Shaft Dia		Pilot Bore D	L	C		t	Bolt Remove Clearance (Z)	Weight (kg)	Transmit Torque T (n.m.)	Max.rpm	Bolt No.	n
	D1	D2			C1	C2							
CL 90	20		11	28	35.5		3	50	1.5	4	4,000	#1	4 - M8 x 50
CL 100	25		11	35.5	42.5		3	56	2.2	10	4,000	#2	4 - M10 x 56
CL 112	28		13	40	50		3	56	2.9	16	4,000	#2	4 - M10 x 56
CL 125	38	30	13	45	60	50	3	64	3.9	25	4,000	#3	4 - M12 x 64
CL 140	42	38	13	50	71	63	3	64	5.4	50	4,000	#3	6 - M12 x 64
CL 160	45		15	56	80		3	64	7.6	110	4,000	#3	8 - M12 x 64
CL 180	50		15	63	90		3	64	10.3	157	3,500	#3	8 - M12 x 64
CL 200	56		21	71	100		4	85	15.7	245	3,200	#4	8 - M20 x 85
CL 224	65		21	80	112		4	85	20.7	392	2,850	#4	8 - M20 x 85
CL 250	75		25	90	125		4	100	30	618	2,550	#5	8 - M24 x 100
CL 280	80		34	100	140		4	116	42	980	2,300	#6	8 - M24 x 116
CL 315	90		41	112	160		4	116	56	1,568	2,050	#6	10 - M20 x 116
CL 355	105		60	125	180		5	150	86	2,450	1,800	#8	8 - M30 x 150
CL 400	110		60	125	200		5	150	109	3,920	1,600	#8	10 - M30 x 150
CL 450	125		65	140	224		5	150	144	6,174	1,400	#8	12 - M30 x 150
CL 560	140		85	160	250		5	150	225	9,800	1,150	#8	14 - M30 x 150
CL 630	160		95	180	280		5	150	298	15,680	1,000	#8	18 - M30 x 150

MT SLEEVE COUPLING

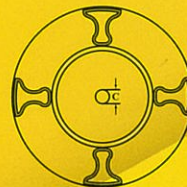
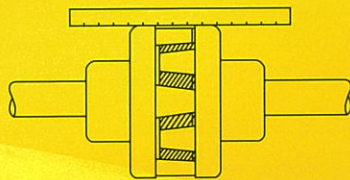
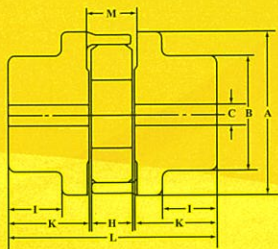

Coupli	Rated Torque (kg-m)		Misalignment		Maximum Speed (r.p.m.)	Dia meter A	Hub B	Bore			L	K	M	N	I	E	Weight (kg)	Moment of Inertia GD ² (kg-m ²)
	Rubber	Urethane	Parallel	Angular				Max.	Min.	Stock C								
MT.50	0.6	0.8	0.2	1°	5,000	50	36	19	-	-	58	22	16	14	13	19	0.5	5.0x10 ⁻⁴
MT.60	1.0	1.5	0.3	1°	5,000	60	42	24	-	-	72	22	28	16	19	26	0.9	1.1x10 ⁻⁴
MT.70	1.6	2.5	0.3	1°	5,000	70	50	28	-	-	75	22	28	19	16	31	1.3	2.5x10 ⁻³
MT.85	3.5	5.0	0.3	1°	4,500	85	56	32	-	-	101	22	40	21	27	35	2.3	5.8x10 ⁻³
MT.100	5.5	8.0	0.3	1°	4,000	100	62	36	-	-	115	22	44	27	30	41	3.3	1.3x10 ⁻²
MT.125	12.0	20.0	0.4	1°	4,000	125	88	48	12	10	147	22	56	35	39	55	7.4	3.9x10 ⁻²
MT.140	16.0	25.0	0.4	1°	3,600	140	100	56	14	12	160	22	62	36	43	54	10.0	7.2x10 ⁻²
MT.170	32.2	45.0	0.4	1°	3,200	170	110	62	22	20	176	22	68	40	46	70	15.0	1.6x10 ⁻¹
MT.185	45.0	60.0	0.5	1°	2,850	185	118	66	22	20	193	22	74	45	51	75	19.8	2.7x10 ⁻¹
MT.200	65.0	90.0	0.5	1°	2,550	200	125	72	22	20	217	22	81	55	57	81	24.9	3.3x10 ⁻¹
MT.225	100.0	140.0	0.5	1°	2,300	225	144	80	27	25	238	22	90	58	62	92	34.4	7.2x10 ⁻¹

